

Illuminated Pushbutton Switches

Specifications:

Contacts:	LTR = rubber contact LTM = metal contact
Contact rating:	LTR 12 V DC, 10 mA LTM 48 V DC, 50 mA max. 1 W
Contact resistance:	LTR < 500 Ω at 2 V DC, 1 mA, at 1,5 N operating force LTM < 100 mΩ at 200 μV AC, 1,5 mA, at 2 N operating force
Insulation resistance:	> 100 MΩ
Dielectric strength:	250 V, 50 Hz for the duration of 1 minute
Operating temperature:	- 25° to + 70° C
Mechanical life:	LTR minimum 100 000 operations LTM minimum 300 000 operations
Contacts:	LTR rubber contact bridge fixed contact phosphor bronze, gold-plated LTM stainless steel, silver-plated
Terminals:	LTR gold-plated LTM silver-plated
Travel:	LTR 1 mm LTM 0,25 mm
Material:	case: PBT meets UL 94 V-0 caps: LTR/LTM 1: ABS LTR/LTM 2: polycarbonat
Soldering conditions:	LTR: auto-soldering – max.: 3 sec, 245° C ± 10° C LTM: auto-soldering – max.: 5 sec, 300° C

Models: Switching functions

without LED

LTR 1

LTM 1

off - mom

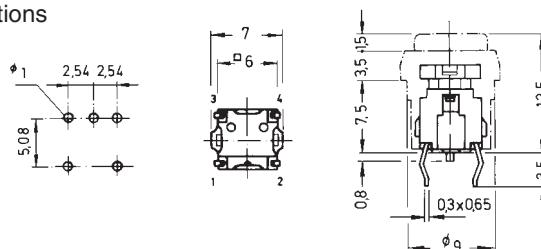

with LED

LTR 2 - L.

LTM 2 - L.

off - mom

- LR (LED red)
- LG (LED green)
- LY (LED yellow)

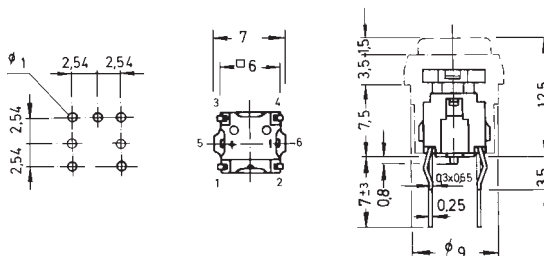

Circuit diagram:

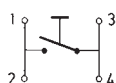

LTR/LTM 2-LR: $I_F = 20 \text{ mA}$; $U_F = 2,0 \text{ V}$
LTR/LTM 2-LG: $I_F = 10 \text{ mA}$; $U_F = 1,95 \text{ V}$
LTR/LTM 2-LY: $I_F = 10 \text{ mA}$; $U_F = 1,90 \text{ V}$





Illuminated Pushbutton Switches

Accessories:

Caps

LTR 1/LTM 1

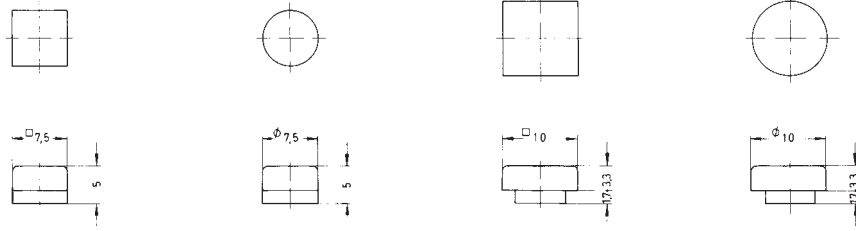

dark grey
grey
light grey
red

KT 7317
KT 7307
KT 7327
KT 7309

KT 7217
KT 7207
KT 7227
KT 7209

KT 8317
KT 8307
KT 8327
KT 8309

KT 8217
KT 8207
KT 8227
KT 8209

3

LTR 2/LTM 2

transparent:

clear
red
green
yellow

KT 7390
KT 7399
KT 7396
KT 7398

KT 7290
KT 7299
KT 7296
KT 7298

KT 8390
KT 8399
KT 8396
KT 8398

KT 8290
KT 8299
KT 8296
KT 8298

Bezels*

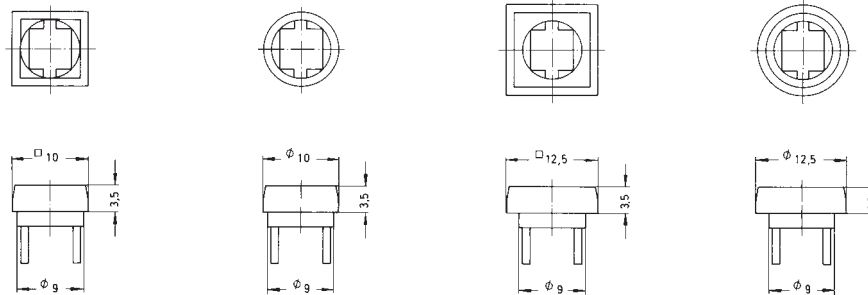

dark grey
grey

FM 7317
FM 7307

FM 7217
FM 7207

FM 8317
FM 8307

FM 8217
FM 8207

* further colours on request