

Subminiature Rotary Coded Switches



Specifications:

Contact rating:	24 V DC, 25 mA switching
Contact resistance:	< 80 mΩ
Insulation resistance:	> 100 MΩ
Dielectric strength:	250 V, 50 Hz for the duration of 1 minute
Operating temperature:	-20° to +70° C
Storage temperature:	-40° to +85° C
Mechanical life:	minimum 10 000 operations
Terminals:	phosphor bronze, gold-plated over nickel barrier
Material:	case: PA6T meets UL 94 V-0, cover light grey, base black rotor: grey, inverse type beige
Mounting:	on pc-board with spacing 2,54 mm
Soldering conditions:	auto-soldering – max.: 5 sec, 260° C

Models: Code

DRS 60010 BCD
 DRS 60110 BCD Inverse
 DRS 60016 Hexadecimal
 DRS 60116 Hexadecimal Inverse

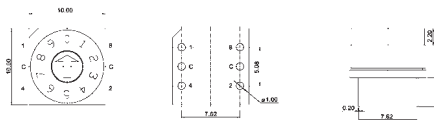

DRS 61010 BCD
 DRS 61110 BCD Inverse
 DRS 61016 Hexadecimal
 DRS 61116 Hexadecimal Inverse

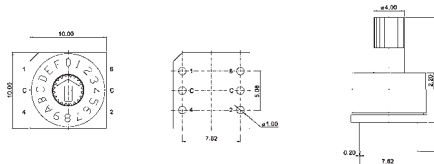

DRR 60010 BCD
 DRR 60110 BCD Inverse
 DRR 60016 Hexadecimal
 DRR 60116 Hexadecimal Inverse

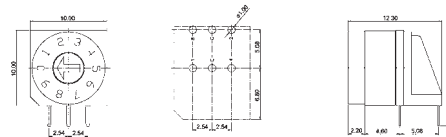

Special version:

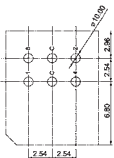

Spacing 2,54 mm

Additional to type number: -1

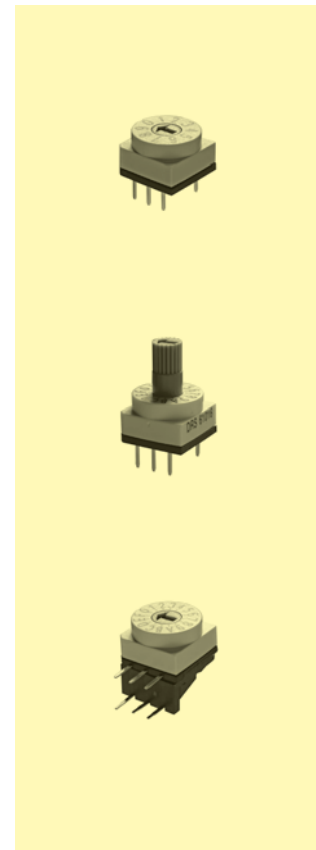



Subminiature Rotary Coded Switches for SMT

Specifications:

Contact rating:	24 V DC, 25 mA ss
Contact resistance:	<80 mΩ
Insulation resistance:	> 100 MΩ
Dielectric strength:	250 V, 50 Hz for the duration of 1 minute
Operating temperature:	-20° to +70° C
Storage temperature:	-40° to +85° C
Mechanical life:	minimum 10 000 operations
Terminals:	phosphor bronze, gold-plated over nickel barrier
Material:	case: PA6T grey meets UL 94 V-0 rotor: PA 66 grey, inverse type blue
Mounting:	on pc-board
Packing:	600 pcs/reel

Models Code

SMR 60010	BCD
SMR 60110	BCD Inverse
SMR 60016	Hexadecimal
SMR 60116	Hexadecimal Inverse

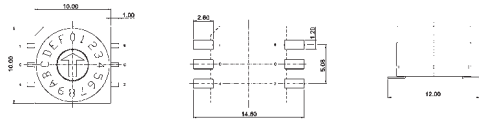

SMR 61010	BCD
SMR 61110	BCD Inverse
SMR 61016	Hexadecimal
SMR 61116	Hexadecimal Inverse

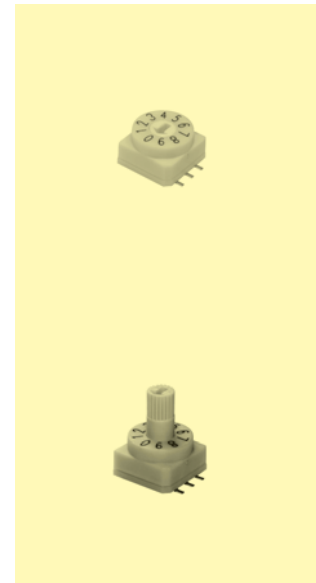
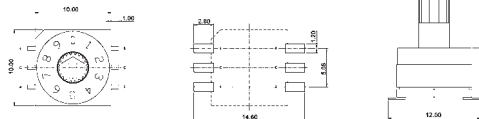

Special versions on request