

Subminiature Toggle Switches for SMT

Specifications:

Contact rating:	max. 20 V AC/DC, 0,4 VA
Contact resistance:	< 20 mΩ
Insulation resistance:	> 1000 MΩ
Dielectric strength:	1000 V RMS at sea level
Operating temperature:	- 30° to + 85° C
Electrical life:	50000 operations at full load
Contacts:	copper alloy, with gold plate over nickel plate
Terminals:	copper alloy, with tin plate over nickel plate
Material:	case and bushing: glass filled nylon 6/6 (UL 94 V-0) actuator: brass, chromium-plated switch support: brass, tin-plated base and stem: thermoplastic nylon meets UL 94 V-0; caps ABS
Mounting:	on pc-board – SMD

2

washable

Model: Switching function

SST 1 DT-R

on - on

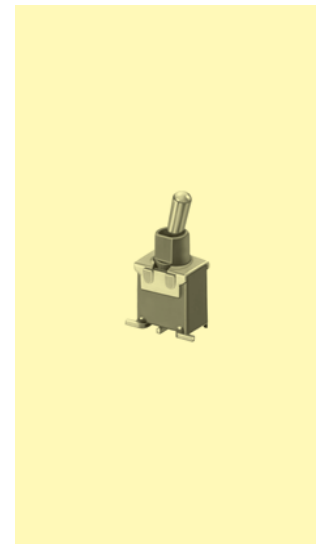
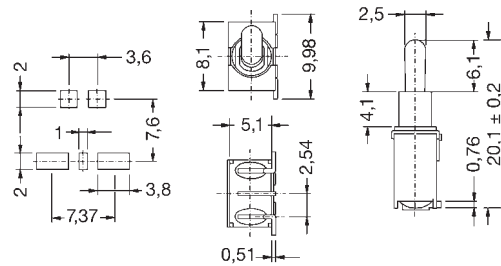

Packing: 500 pcs/reel

