

Dual-in-line Switches

Specifications:

Contact rating:	50 V DC, 100 mA
Contact resistance:	< 50 mΩ
Insulation resistance:	> 1000 MΩ at 100 V DC
Capacity:	< 5 pF between 2 poles
Dielectric strength:	500 V, 50 Hz for the duration of 1 minute
Operating temperature:	- 20° to + 80° C
Mechanical life:	minimum 5000 operations per pole
Shock resistance:	contact interruption < 10 μsec with triple shock in all 6 directions, shock conditions: 20 G, 11 msec duration (sine half wave)
Vibration:	contact interruption: < 10 μsec at vibration test in accordance with MIL-STD-202 D, method 204, condition C
Contacts:	copper beryllium, 0,3 μm gold-plated over 1 μm nickel
Terminals:	PC terminals, nickel silver, 0,3 μm gold-plated over 1 μm nickel
Material:	case: PBTP; slide: PA
Construction:	case sealed series 700: slide recessed, sealed with protective tape
Mounting:	on pc-board
Slide position:	OFF
Soldering conditions:	auto-soldering – max.: 3 sec 270° C

Models:

Series DSS 700

Type	Poles	Length (A)
DSS 702	2	6,3 mm
DSS 703	3	8,8 mm
DSS 704	4	11,4 mm
DSS 705	5	13,9 mm
DSS 706	6	16,4 mm
DSS 707	7	19,0 mm
DSS 708	8	21,5 mm
DSS 710	10	26,6 mm

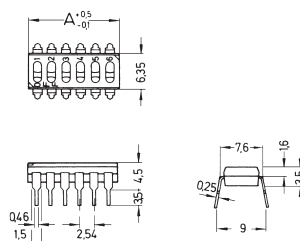

Series DSS 800

Type	Poles	Length (A)
DSS 802	2	6,3 mm
DSS 803	3	8,8 mm
DSS 804	4	11,4 mm
DSS 805	5	13,9 mm
DSS 806	6	16,4 mm
DSS 807	7	19,0 mm
DSS 808	8	21,5 mm
DSS 810	10	26,6 mm

