

# Miniature Slide Switches

## Specifications:

Contact rating:	125 V AC, 100 mA / 60 V DC, 100 mA
Contact resistance:	< 10 mΩ
Insulation resistance:	> 1000 MΩ, at 500 V DC
Dielectric strength:	1000 V, 50 Hz for the duration of 1 minute
Mechanical life:	minimum 30 000 operations
Operating temperature:	- 45° to + 85° C
Contacts/Terminals:	PC terminals, copper alloy with 2 μ gold-plating over 3 μ nickel barrier
Material:	case: diallyl-phthalate, cover and slide: Noryl SE 0
Mounting:	on pc-board
Soldering conditions:	auto-soldering – max.: 5 sec, 260° C ± 5° C hand-soldering – max.: 20 W, 5 sec, 270° C

## 4

## Models: Switching functions

S P D T

MSS 101 DB

on – on

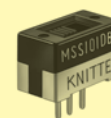
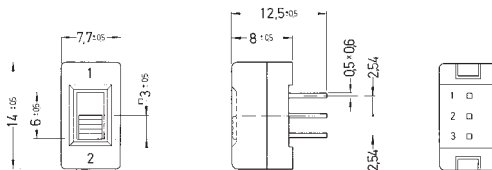

S P D T

MSS 111 DB

on – on

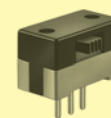
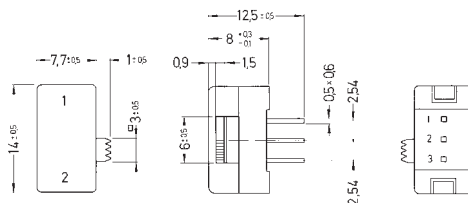

D P D T

MSS 201 NB

on – on

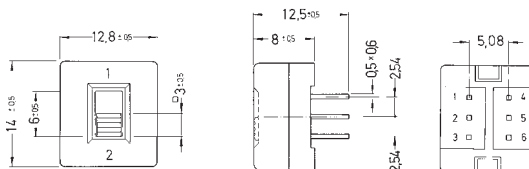



# Miniature Slide Switches

## Specifications:

Contact rating:	250 V AC, 1 A / 120 V AC or 28 V DC, 3 A
Contact resistance:	< 100 mΩ
Insulation resistance:	> 1000 MΩ
Dielectric strength:	1000 V, 50 Hz for the duration of 1 minute
Operating temperature:	-40° to +85° C
Mechanical life:	minimum 20 000 operations
Material:	Actuator: nylon, black Case: nylon, black Base: nylon, white
Contacts/Terminals:	copper alloy, silver-plating
Soldering conditions:	auto-soldering – max.: 5 sec, 260° C ± 5° C

## Models: Switching functions

MSS 3011 D on – on

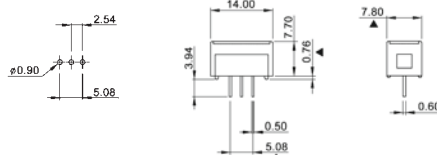

MSS 3112 D on – on

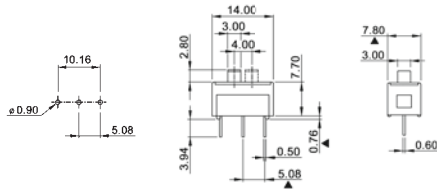

MSS 3121 N-R on – on

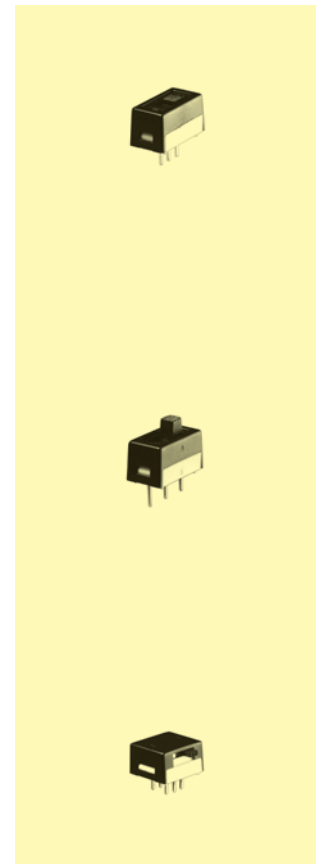
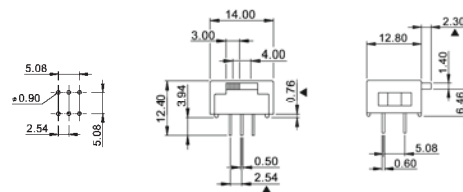

## Ordering code:

MSS 3

### Actuator:

- Recessed
- Raised

### Terminal spacing:

- 2,54 mm
- 5,08 mm

- Top actuated
- Side actuated

### Number of Poles:

- Single pole
- Double pole

### Switching function:

- SP, ON – ON
- DP, ON – ON