

Recommend operating area $\varnothing 2\text{mm}$

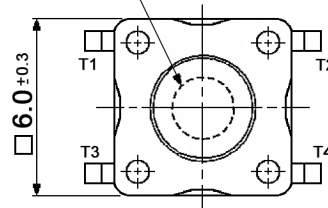

CIRCUIT DIAGRAM

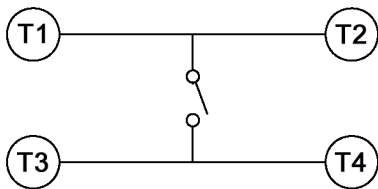

P.C.B. LAYOUT

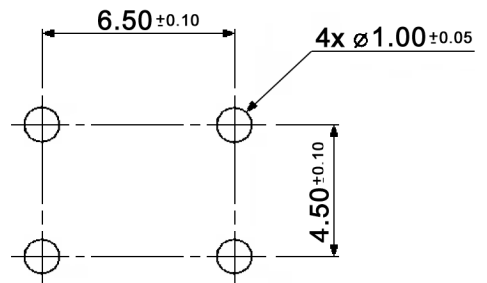

Compliance: RohS II (2011/65/EU)

| Tolerances: up to 10: $\pm 0.2\text{mm}$ above 10-50: $\pm 0.3\text{mm}$ | | Date | Name | <h1>TS 66 x</h1> <h2>30 33 99</h2> | Page |
|---|------|-----------------------|------|---------------------------------------|------|
| | | 08/15 | dr | | |
| | | | | | |
| | | | | | |
| | | | | | |
| | | knitter-switch | | | |
| Modifications | Date | Name | | | 1/2 |

Specifications:

Contact rating: 50mA, 12V DC
 Contact resistance: 100mOhm max.
 Insulation resistance: 100MOhm min. at 500V DC for 1 minute
 Dielectric strength: 250V AC (50/60Hz) for 1 minute
 Operating temperature: -40°C to +85°C
 Storage temperature: -40°C to +85°C
 Soldering conditions: pre-heat: max. 100°C, max. 60sec.
 wave soldering: max. 265°C, max. 5sec.
 Material: Cover: stainless steel
 Stem / base: PPS, UL94V-0
 Contact: phosphor bronze, silver plated over nickel
 Terminal: brass, silver plated over nickel
 Soldering conditions:

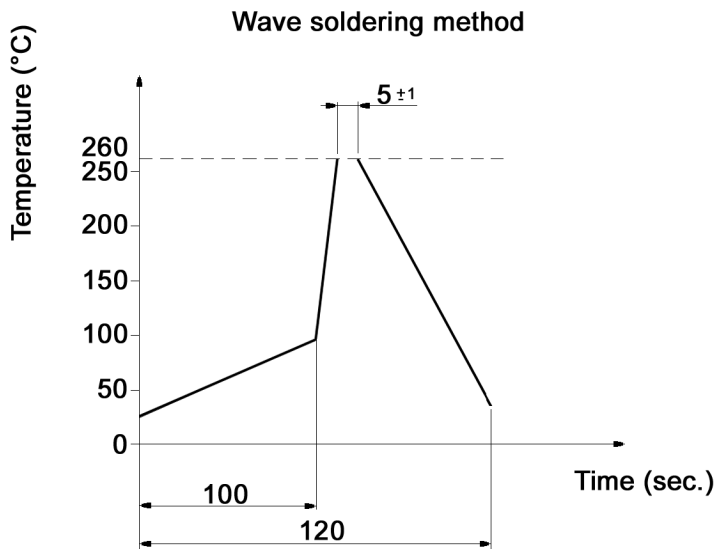

| x | Operating force | Mechanical life | Stem color |
|---|-----------------|-----------------|------------|
| K | 100 +/-30 gf | 150 000 cycles | black |
| N | 160 +/-50 gf | 150 000 cycles | brown |
| R | 250 +/-70 gf | 150 000 cycles | red |
| S | 320 +/-70 gf | 100 000 cycles | salmon |
| Y | 520 +/-130 gf | 50 000 cycles | yellow |

Compliance: RohS II (2011/65/EU)

| | | | | |
|---|------|-------|-----------------------|-----------------|
| Tolerances: up to 10: ±0.2mm above 10-50: ±0.3mm | | Date | Name | TS 66 x |
| | | 08/15 | dr | |
| | | | | |
| | | | | |
| | | | knitter-switch | 30 33 99 |
| | | | | |
| Modifications | | | | 2/2 |
| Date | Name | | | |